



WARRANTY REGISTRATION

Scan QR code or go to below URL to register your
ONE YEAR complimentary Warranty:



Scan this code

airdoctorpro.com/warranty

Perks of being an AirDoctor registered owner:



Exclusive Promotions

Big savings & exclusive promotions
for AirDoctor owners.



Helpful Tips

Tips and seasonal advice about how to
get the most out of your AirDoctor.



Be in the Know

Registered AirDoctor owners find
out first about new technology and
product announcements.

INSIDE PANEL

Love Your AirDoctor?



Leave a review and help others out
by sharing your experience.



Scan this code

airdoctorpro.com/feedback



Breathe Easy Guarantee

AirDoctor is backed by our 30 day Breathe Easy money back guarantee. Try AirDoctor in your home for 30 days. If you do not love it, simply contact us to return the product and receive a full refund of your purchase price, less shipping and processing. No questions asked.

Need Help?

Contact us. We want to help. | airdoctorpro.com/support

Email: info@airdoctorpro.com

Toll-Free: 1.800.221.2515

Support Hours

Monday-Friday, 7am-4pm PST/PDT

Saturday, 7am-3pm PST/PDT

01.24.R1



Follow Us! @AirDoctorPro

BACK COVER



QUICK START GUIDE

SMART AD2000i AIR PURIFIER



FRONT COVER

AD-2000i_Quick_Start_Guide-Product_Card_02.24_R1 / 02.08.24

Fold / Trim : 6" W x 9" H (Tri-Fold)
Flat: 18" W x 9" H with .125 bleeds all sides
Color: 4C Process

WARNING!

Read, understand, and follow all instructions and safety information in the Manual before installing and using this product.

Getting Started

Before first use, remove filters and **remove plastic bag from filters**, then reinstall filters.

Then reinstall front cover. Plug the unit into an electrical outlet. The unit will be ready to run. Read the following directions to select desired settings.

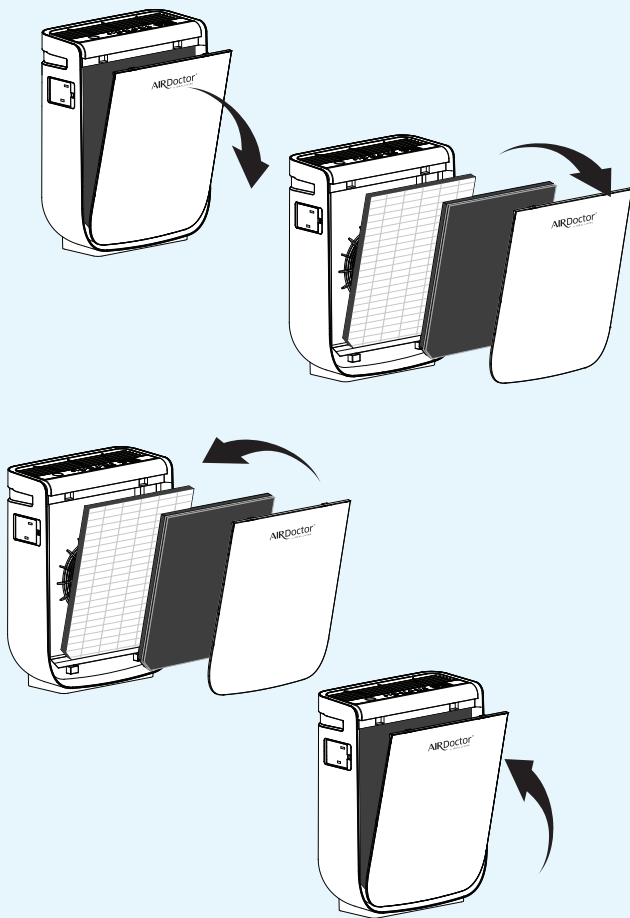

The importance of Genuine AirDoctor Replacement Filters!

Genuine AirDoctor replacement filters are guaranteed by AirDoctor and independently tested to remove dangerous airborne contaminants. Generic (third-party) aftermarket filters may be of questionable quality and may not be tested for effectiveness. They are also not certified to work with AirDoctor. For air quality you can trust, and to maintain the optimal performance you depend on from AirDoctor, always use genuine AirDoctor replacement filters.

Notice: Damage caused by third party replacement filters is not covered by your warranty.

Using Your AirDoctor

Power Control

As soon as you press the power button , the AirDoctor will start in the **Auto** mode. Once the Auto mode has been activated, it will start up in the high-speed mode, and then the sensor will start to detect the amount of particulate matter in the air. As the particles are detected, the AirDoctor will automatically adjust to the purification speed (fan speed) that is appropriate to the particulate contamination in the room.

In most cases, we recommend that you leave the AirDoctor in the Auto mode. For other purification modes, see below.

FOR MAXIMUM EFFECTIVENESS, RUN 24/7 IN AUTO MODE

Air Quality Monitor

The AirDoctor features an Air Quality Monitor that continuously monitors the quality of air in a room. The LED indicator light, located on the top of the unit, will change colors based on the air quality in the room. The Air Quality Monitor is able to show three air quality levels.

- BLUE** = Good air quality
- ORANGE** = Moderate air quality
- RED** = Poor air quality

Using Auto Mode

You can choose to set the AirDoctor to **Auto**. This will enable the AirDoctor to adjust the fan speed according to the air quality. In **Auto** mode, the fan speed will be adjusted as follows:

- Good Air Quality** = Fan Speed 1
- Moderate Air Quality** = Fan Speed 2
- Poor Air Quality** = Fan Speeds 3 and 4

Please Note: The blue light indicates that AirDoctor is maintaining healthy air quality. We recommend that you keep the unit in Auto mode as it will automatically adjust to the purification needs of the room.

Product Overview

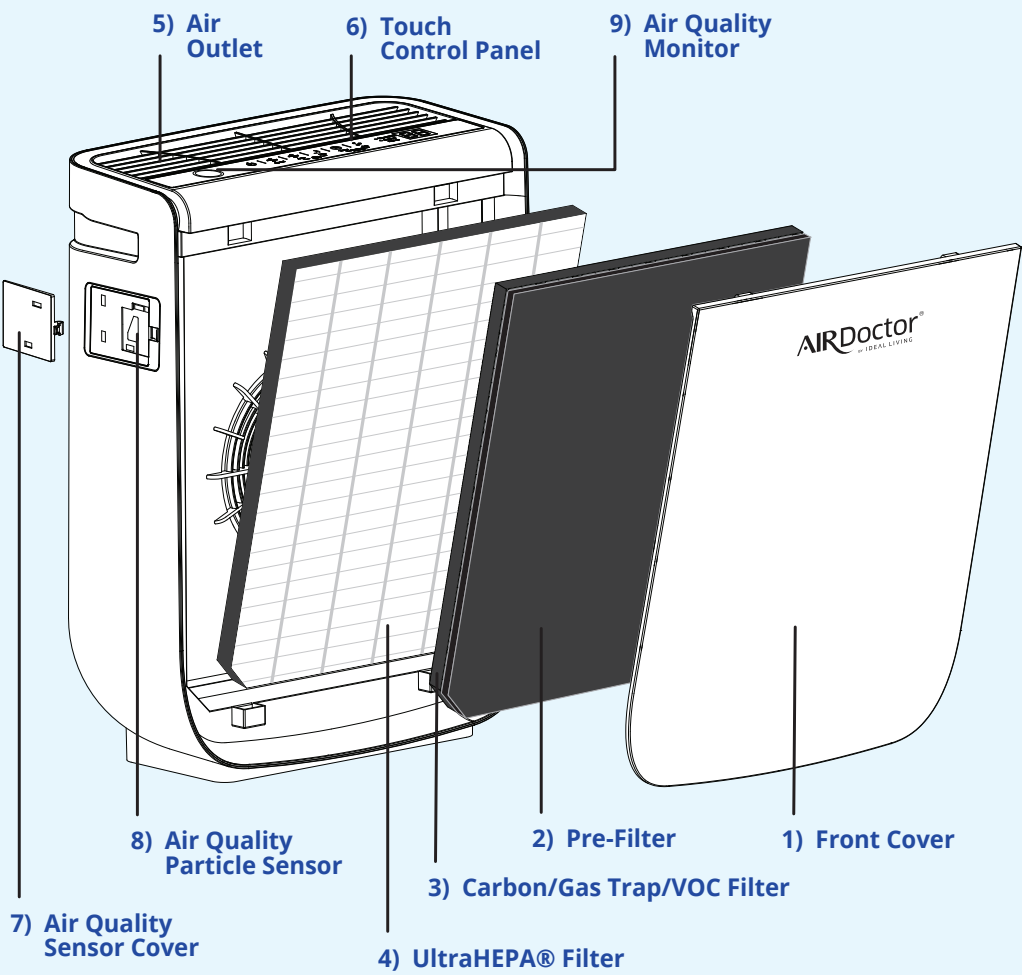

Control Panel

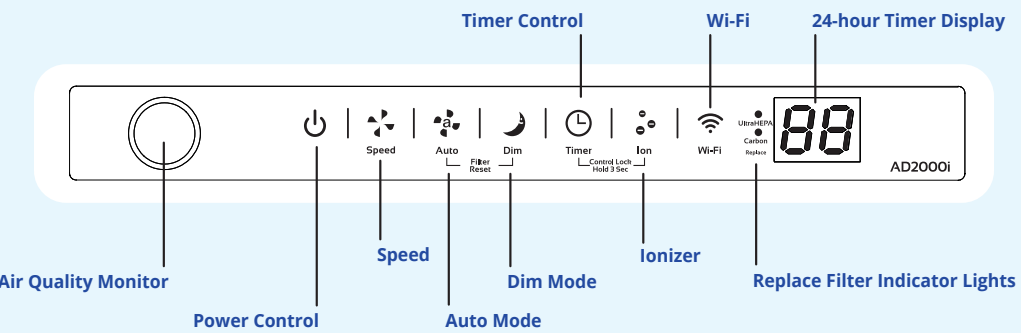

Note: See Product Manual for more details on these functions.