

**AQUATru**<sup>®</sup>  
BY IDEAL LIVING

PRO SERIES



**AQUATru**<sup>®</sup>  
BY IDEAL LIVING

PRO SERIES

## On-Wall Bi-Level Bubbler with Bottle Filler

Owner's Manual

Please Read and Save these Instructions

[AquaTruPro.com](http://AquaTruPro.com)

©2024 AquaTru, LLC. All Rights Reserved. 11.24.R1



The ATW-1-FAC, ATW-1-FBAC, and ATW-1-FBLAC systems have been certified by IAPMO R&T against NSF/ANSI Standards 42, 53 and 401 for the reduction claims specified on the performance data sheet and substantiated by test data at IAPMO.org.



Control Number  
802177

## Table of Contents

<b>READ BEFORE USE - Warnings and Safety Information</b>	<b>2</b>
<b>System Specifications</b>	<b>5</b>
<b>System Dimensions</b>	<b>6</b>
<b>Main Parts</b>	<b>7</b>
<b>Packing List</b>	<b>9</b>
<b>Tools and Supplies</b>	<b>10</b>
<b>Installation Guide</b>	<b>11</b>
<b>Filter Replacement Instructions</b>	<b>20</b>
<b>Control Panel</b>	<b>22</b>
<b>Service</b>	<b>23</b>
<b>Service: Wiring Diagram</b>	<b>24</b>
<b>Error Codes</b>	<b>24</b>
<b>Warranty Information</b>	<b>25</b>
<b>Arbitration Agreement</b>	<b>27</b>
<b>Main Parts - SKU Listing</b>	<b>29</b>

## Read Before Use

### **WARNING:**

**Do not use with water that is microbiologically unsafe or of unknown quality without adequate disinfection before the system.**

**To avoid product or property damage, personal injury, or even possible death, carefully read, understand, and follow all the instructions in this installation and User Manual before installing this product. Save this manual.**

**The system is to be supplied only with cold water.**

**Improper installation of this product could cause a dangerous situation that results in injury or death.**

**Manufacturer highly recommends a licensed plumber perform installation of product to avoid risk of damages not covered by the warranty.**

**Do not operate power tools unless you read and understand the instructions and warnings in this and all other applicable labels or manuals. Proper use of tools and the products described in this guide is your responsibility.**

**Failure to follow these instructions could result in personal injuries, water damage, and other damage to floors, pipes, walls, and other portions of your building or home.**

**Any and all refrigeration system components found inside this device must be serviced by authorized personnel only.**

**Take care when moving or handling this device. Damage to this system can cause refrigerant to leak.**

#### **Disclaimer:**

The information contained in this Installation and User Manual is given free of charge. It is based upon technical data which we believe to be reliable and is intended for use by persons having knowledge of this technical area at their own discretion and risk. AquaTru assumes no responsibility for results obtained or damage incurred from the use of this material either in whole or in part by the buyer.

## Read Before Use





### WARNING:

**You must read and understand the contents of this manual before installing or operating your drinking system. These warnings indicate a potentially hazardous situation which, if not avoided, could result in serious injury or death. Follow all instructions related to the installation and/or maintenance of this product (unit).**

- Always consult with local plumbing and building regulations for installation.
- This device uses only 120V 60hz AC Power.
- Keep all ventilation clear of obstructions.
- Use only with an outlet protected by a ground fault circuit interrupt device.
- Do not use a power strip or extension cord
- Service should be completed only by a certified technician.
- Do not use the device in conditions outside of the listed operational parameters.



### Personal Protection

Be sure to use all personal protective equipment, such as sturdy safety glasses, work shoes, hearing protection, and gloves, whenever necessary, to ensure your own safety while installing the water cooler.

-  To avoid eye injury, always wear protective glasses with side shields when using power tools. Also, make sure no one else can be injured by flying particles when using power tools.
-  To prevent possible damage to your hearing, always wear ear protection, such as earmuffs or earplugs when using power tools.
-  This product is heavy and can cause bodily injury due to its weight or if the unit is dropped. Use two people to lift the product when unpacking the unit or installing it onto the hanger brackets. Wear protective gloves during installation to protect against sharp edges from sheet metal components.
-  Wear protective shoes during installation to protect against sharp edges from sheet metal components.



### Lifting Hazard

To avoid personal injury, always use these proper lifting techniques and use two people to move heavy cartons.

-  Use appropriate lifting devices to move the load.
-  Always use two people when lifting heavy or bulky cartons.
-  DO NOT attempt to lift objects that are too heavy.

### Power Tool Hazard





To prevent personal injury or possible death, always follow the electrical safety recommendations of the power tool's manufacturer.

-  Do not use power tools in an unsafe manner.
-  Power tools should only be connected to a circuit protected by a ground-fault circuit interrupter (GFCI). If an extension cord is required, always use an OSHA approved extension cord.

## Read Before Use

### Shock and Electrocuting Hazards

Failure to follow these instructions could result in severe burns, significant injuries, and even death. Water will conduct electric current to create a short circuit, resulting in injury or death. If the electrical cord is damaged, it must be replaced by the manufacturer, its service agents, or a similarly qualified person to avoid hazard.

- Never use electric power tools around water or wet floors/surfaces.
- Keep all liquids away from electrical cords and power tools.
- If an extension cord is required, always use an OSHA approved cord.
-  DO NOT create a short circuit between a source of electricity and a liquid by being in contact with both simultaneously. Contacting live electrical wiring with power tools or hand tools can cause serious injury or death.
-  Prior to installation, make sure all related circuit breakers are turned OFF.
-  Test for live circuits or wiring inside any wall where installation of the product requires cutting into a wall. Prior to any maintenance, make sure the unit is unplugged and circuit breakers are turned OFF.
-  Prior to installation, test for live circuits or wiring inside the wall before cutting or drilling into the wall.

### Flammable Refrigerant

This device uses flammable refrigerant. To reduce the risk of fire or explosion, only dispose of in accordance to Federal and Local Regulations.

- To avoid either damaging the refrigerant tubing or increased risk of a leak, always take care and follow Local and Federal regulations while handling or moving the device.
- To minimize the risk of possible ignition due to incorrect parts or improper service, the parts of the water cooler shall be replaced with like components and servicing shall be done by factory authorized personnel.

### CAUTION:

These cautions indicate a potentially hazardous situation which, if not avoided, may result in minor or moderate injury.

- Follow all instructions related to installation and/or maintenance of this product.

### Tripping Hazard

Personal injury can result from tripping over power cords, tools, or other installation items.

- DO NOT leave items lying around the work area.

### Cutting Hazard

The installation of this product may require using power tools.

- Keep hands away from the cutting edge of any tool used in the installation of this product.
- Placing fingers in or around the cutting blades could result in serious personal injury.



## System Specifications

This system and its installation must comply with State and Local Regulations. Check with your Local Public Works Department for plumbing and sanitation codes. Local codes should be followed in the event the codes conflict with any content in this manual.

<b>Product Name</b>	AquaTru On-Wall Bi-Level Bubbler with Bottle Filler
<b>Model #</b>	ATW-1-FBLAC
<b>Operating Pressure</b>	20 - 110 PSI
<b>Operating Temperature</b>	40 - 100 °F
<b>Rated Flow Rate</b>	1 GPM
<b>Rated Capacity</b>	3000 gallons
<b>Electrical Source</b>	120V/60Hz AC
<b>Max Rated Current</b>	6.5A
<b>Refrigerant</b>	R290 (Propane)
<b>Refrigerant Weight</b>	50g
<b>Refrigerant LFL</b>	0.038kg/m <sup>3</sup>
<b>Dimensions (L x W x H)</b>	21" X 37" X 39.4"
<b>Number of Stations Served</b>	2
<b>Installation Location</b>	Indoors or outdoors if fully covered
<b>Filter Component</b>	ATW1-F1 (SKU:10AT02CF01)

## System Dimensions





## Main Parts

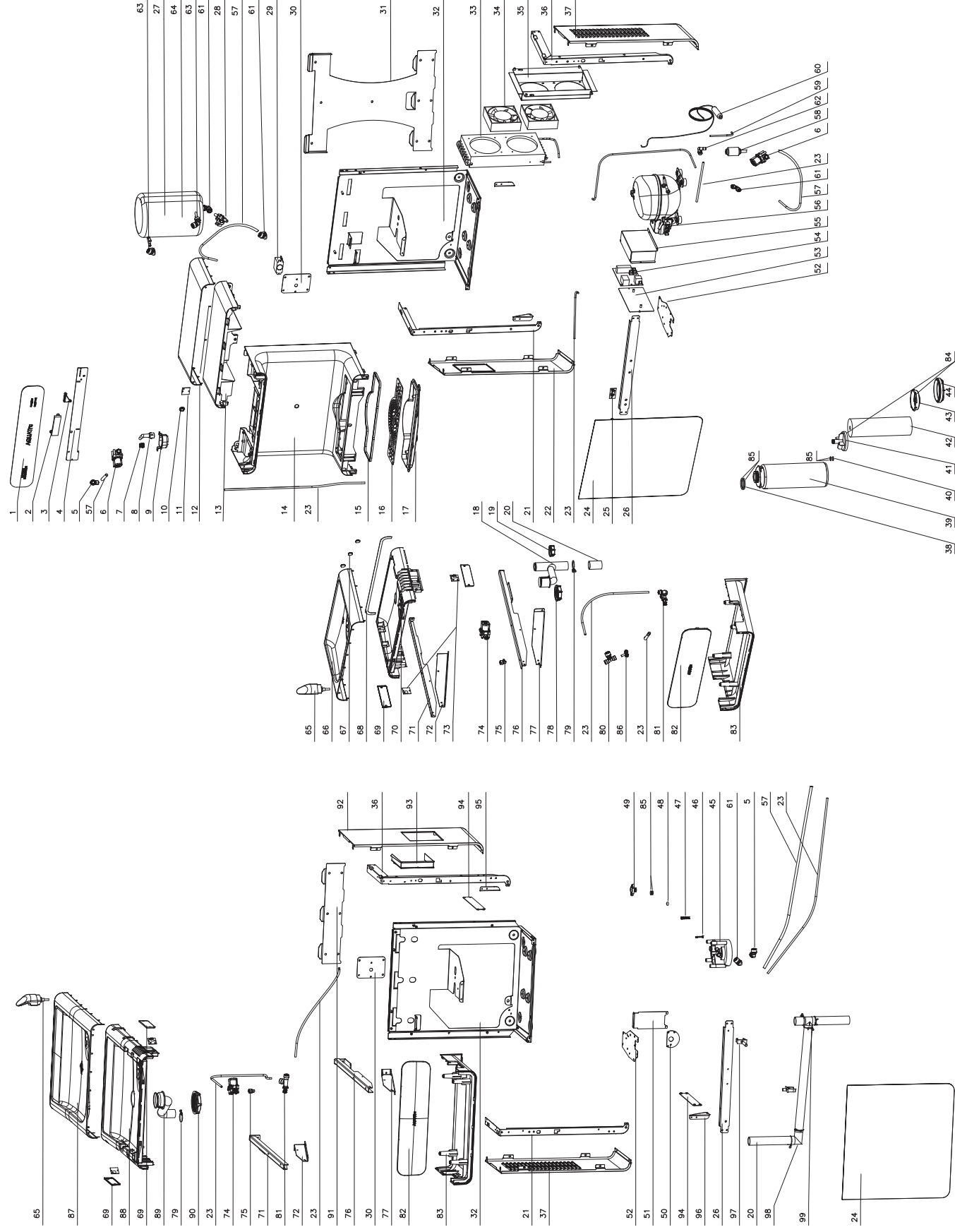

## Main Parts

- |                                |   |   |
|--------------------------------|---|---|
| 1 Control Panel                | 34 Fan  | 65 Bubbler                              |
| 2 Display Guide                | 35 Fan Cowling                                  | 66 Basin                                |
| 3 Light Cover                  | 36 Right Side Frame                             | 67 Silicone Bumper                      |
| 4 Screen PCB                   | 37 Side Panel                                   | 68 Silicone Bumper Gasket               |
| 5 Elbow Connector 1/4" to 3/8" | 38 Big O-ring                                   | 69 Hand Sensor Cover                    |
| 6 3/8" Solenoid Valve          | 39 Filter Base                                  | 70 Basin Support                        |
| 7 Laminar Flow Fitting         | 40 Small Oring                                  | 71 Basin Left Cantilever Support        |
| 8 Dispensing Tube              | 41 Carbon Top Cap                               | 72 Basin Left Triangulated Support      |
| 9 Dispensing Tube Cover        | 42 Carbon Block                                 | 73 Right Side IR Sensor Cover           |
| 10 Bottle Sensor Lens          | 43 Carbon Bottom Cap                            | 74 1/4" Solenoid Valve                  |
| 11 Bottle Sensor               | 44 Filter End Cap                               | 75 Connector 1/4 X 1/4 (Male to Female) |
| 12 Dispenser Top               | 45 Filter Manifold                              | 76 Bubbler Right Cantilever Support     |
| 13 Top Cover Support           | 46 Valve Stem                                   | 77 Basin Right Triangulated Support     |
| 14 Bottle Dispenser            | 47 Spring                                       | 78 Small Basin Drain Lock               |
| 15 Drip Tray Gasket            | 48 Flow Wiper                                   | 79 Spring Fastener                      |
| 16 Drip Tray                   | 49 Flow Wiper Cover                             | 80 T-Joint 1/4 X 3/8 X 1/4              |
| 17 Drain Basin                 | 50 NFC Reader                                   | 81 Throttle Valve                       |
| 18 Drain Tube Boot             | 51 NFC Mounting Bracket                         | 82 Basin Front Cover                    |
| 19 Drain Tube Lock Collar      | 52 Filter Manifold Bracket                      | 83 Basin Bottom Cover                   |
| 20 Short Drain Tube            | 53 Control Board Mounting Bracket               | 86 T-Joint 1/4 X 1/4 X 1/4              |
| 21 Left Frame                  | 54 Bubbler Control Board                        | 87 Large Basin                          |
| 22 Side Panel                  | 55 Control Board Cover                          | 88 Large Basin Support                  |
| 23 1/4" PE Tube                | 56 Compressor                                   | 89 Drain Hose Assembly                  |
| 24 Front Panel                 | 57 3/8" PE Tube                                 | 90 Large Basin Drain Lock               |
| 25 Bottle Counter Reset Switch | 58 Pressure Regulator                           | 91 Small Wall Bracket                   |
| 26 Front Brace                 | 59 Copper Pipe                                  | 92 Right Side Panel-Shell Unit          |
| 27 Evaporator (Tank)           | 60 Refrigerant Filter                           | 93 Pass-Through Cover                   |
| 28 Flow Meter                  | 61 Elbow Connector 3/8" to 3/8"                 | 94 Strengthening Plate                  |
| 29 Thermostat                  | 62 Connector 1/4 to 3/8 (Female to Male)        | 95 Right Stiffener Plate                |
| 30 Thermostat Mount            | 63 Elbow 5/16 to 3/8                            | 96 Left Stiffener Plate                 |
| 31 Wall Mounting Bracket       | 64 Elbow Connector 1/4 X 3/8 (Female to Female) | 97 Tube Support                         |
| 32 Back Panel                  |   | 98 Elbow Drain Boot                     |
| 33 Condenser                   |   | 99 T - Drain Boot                       |

## Packing List

Inspect the **AquaTru On-Wall Bottle Filler With Bubbler** for any shipping damage.

Handle all components of the system with care. Do not drop, drag, or turn unit upside down. Doing so can result in refrigerant leaks or other product damage and may result in unsafe operating conditions.

The manufacturer is not responsible for damages in transit. Small parts, needed to install the drinking system, are in a parts box. To avoid losing the small parts, keep them in the parts box until they are needed for installation.

### Package Contents:

1. Assembled Bubbler and Bottle Filler Main Unit
2. Mounting Brackets
3. Drain Tube
4. Manual
5. ATW1-F1 Chlorine and Lead Filter
6. Shell Bubbler Unit

## Tools and Supplies

### Before Installation

- Check the accessories in the packing box and confirm everything is present.
- Shut off the water supply.
- Prepare the below list of tools and equipment needed for the installation.
- Shut off the Electrical Breaker.

### Summary of Installation

1. Select the system installation location.
2. Reconfigure the units as needed.
3. Mount the hanger brackets.
4. Mount the Unit.
5. Make connections to the Water Supply.
6. Make connections to the drain.
7. Plug in the unit and open the water supply valve.
8. Flush the Filter.
9. Adjust Bubbler Flow.
10. Close the unit.

### Tools Needed for Installation

1. Tape Measure
2. Level
3. Power Drill
4. Adjustable Pliers
5. Adjustable Wrench
6. Hacksaw
7. Long Reach Screwdriver
8. T20 Driver
9. Tubing Cutters

### Components Required for Installation Not Included in the Box

1. Lag screws or wall anchors (Recommend 15 x 1/4" diameter and 2 x 7/16" diameter. Screws should be long enough to engage with at least 2 inches of support material.)
2. Flat Washers
3. P-Trap with 1-1/4" Inlet
4. Quarter Turn Shut-off Valve with angled 3/8" outlet
5. Flexible 3/8" Tubing and 3/8" Tubing Unions

# Installation Guide

## Right Hand High Bottle Low (Standard)

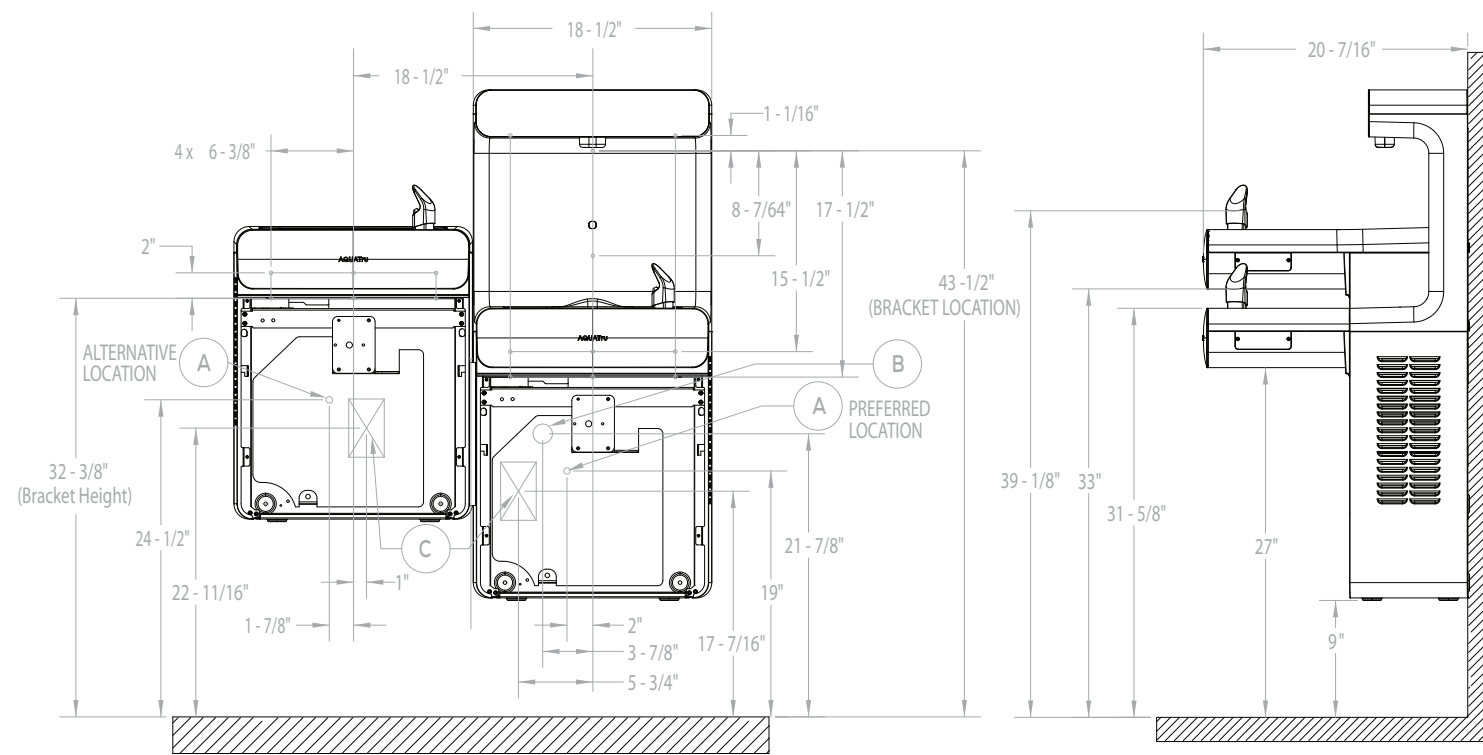

- A. RECOMMENDED LOCATION FOR 3/8" WATER VALVE
- B. DRAIN LINE LOCATION
- C. ELECTRICAL OUTLET LOCATIONS

# Installation Guide

## Alternative (Left Hand High Bottle High)

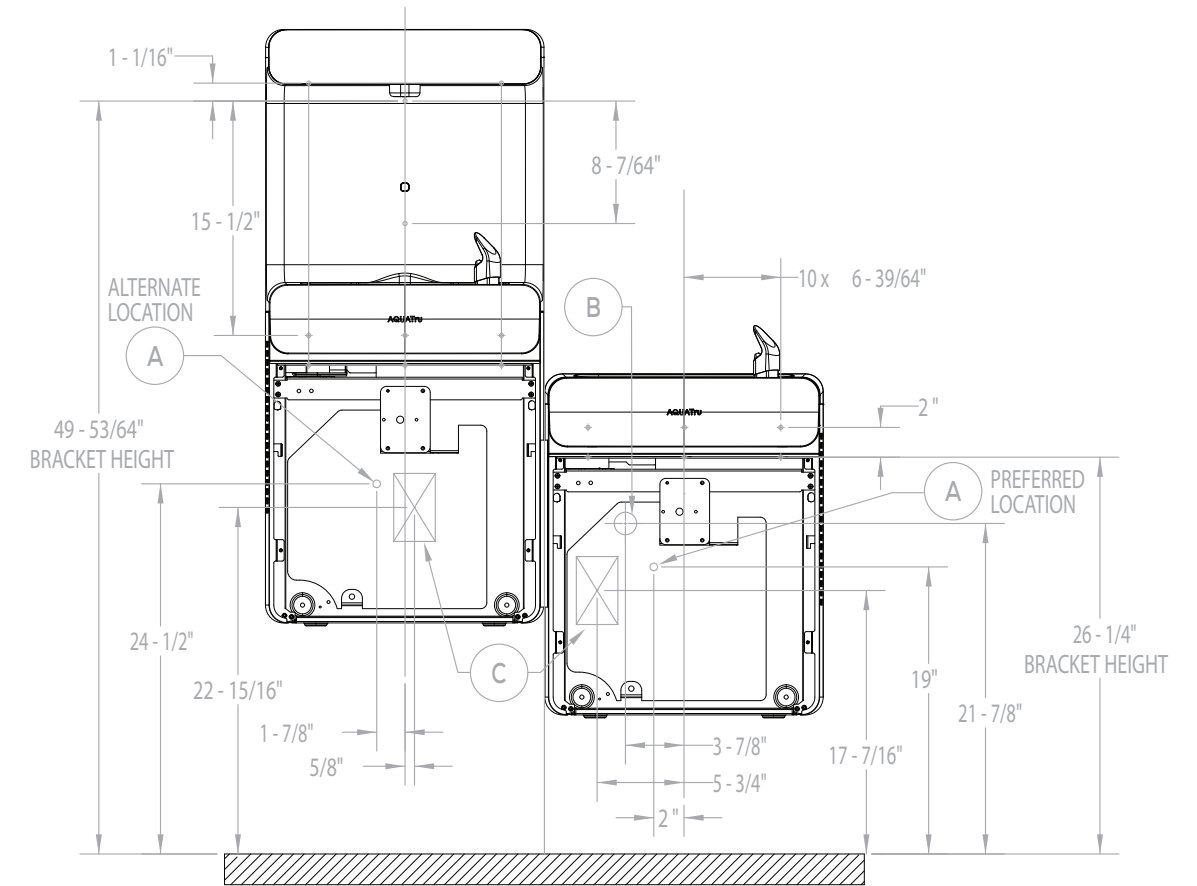

- A. RECOMMENDED LOCATION FOR 3/8" WATER VALVE
- B. DRAIN LINE LOCATION
- C. ELECTRICAL OUTLET LOCATIONS



# Installation Guide

## Alternative (Right Hand High Bottle High)

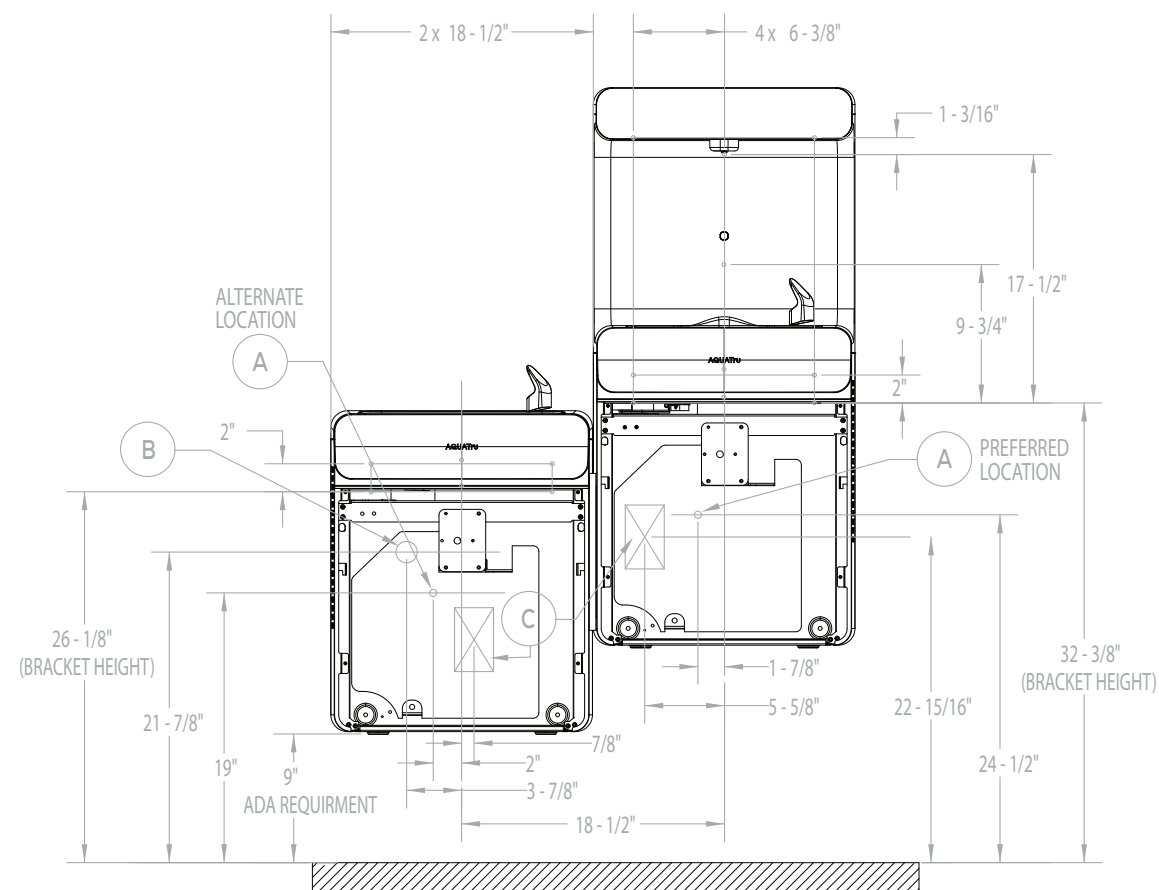

- A. RECOMMENDED LOCATION FOR 3/8" WATER VALVE
- B. DRAIN LINE LOCATION
- C. ELECTRICAL OUTLET LOCATIONS

# Installation Guide

## Alternative (Right Hand High Bottle Low)

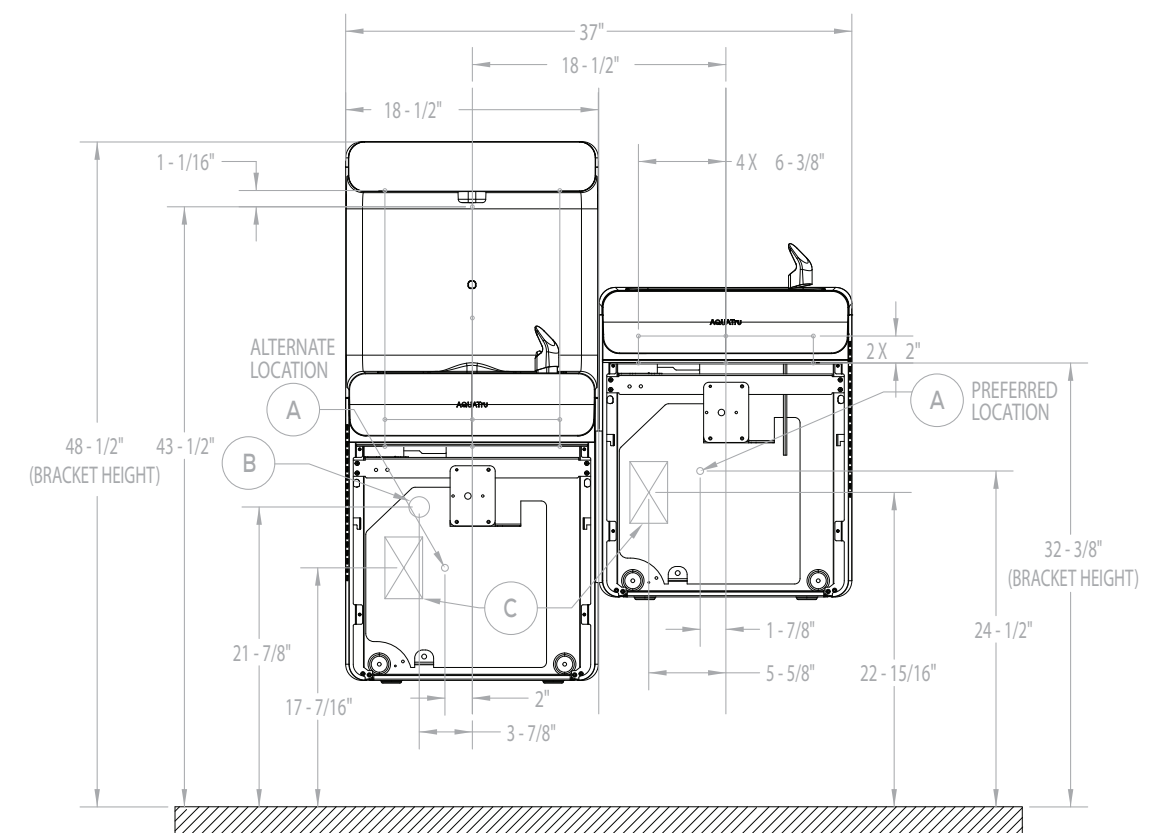

- A. RECOMMENDED LOCATION FOR 3/8" WATER VALVE
- B. DRAIN LINE LOCATION
- C. ELECTRICAL OUTLET LOCATIONS

# Installation Guide

**MANUFACTURER HIGHLY RECOMMENDS A LICENSED PLUMBER PERFORM INSTALLATION OF PRODUCT TO AVOID RISK OF DAMAGES NOT COVERED BY THE WARRANTY.**

## STEP 1

### Installation of the Hanger Brackets

- 1.1 After Modifying the units as needed, determine which side will house the Drain line. **THIS WILL NEED TO BE THE LOWER OF THE TWO SIDES.**
- 1.2 Referencing the drawings on pages 11-14 find the centerline of the lower of the two units.
- 1.3 Measure up the wall from the floor according to the bracket heights mentioned in the installation diagrams (the most common will be 43 - 1/2" for the refrigerant side) and find the wall bracket locating point. (Fig 1A)
- 1.4 Prepare the newly marked location for the appropriate anchor type and make sure that your AquaTru is securely mounted to the wall.
- 1.5 Hang the bracket from that point and mark all of the remaining bracket holes making sure that the bracket is level while you do so.
- 1.6 Pre-drill or otherwise prepare the wall for the wall anchors where you want to install the Bubbler.
- 1.7 Level the hanger bracket and mark all the mounting holes without moving the mounting bracket out of level.
- 1.8 Remove the wall bracket and install all the other anchor points according to the wall material you are mounting on.
- 1.9 Reattach the bracket and make sure you use all the necessary wall anchors. (Fig 1B)
- 1.10 Now measure 18 1/2" from the center of the first bracket you installed to find the center line of the second hanger bracket. (Most commonly this will be 32-3/8")
- 1.11 Measure up the wall from the floor according to the bracket height for the second half of the unit and scribe a line. This is the mounting reference point for the second wall bracket.
- 1.12 Install the appropriate wall anchor and hang the bracket from that point.
- 1.13 Level the Second Bracket and mark all of the remaining mounting points.
- 1.14 Remove the bracket and install the remaining anchor points.
- 1.15 Now attach the bracket using all needed anchors.



Fig 1A

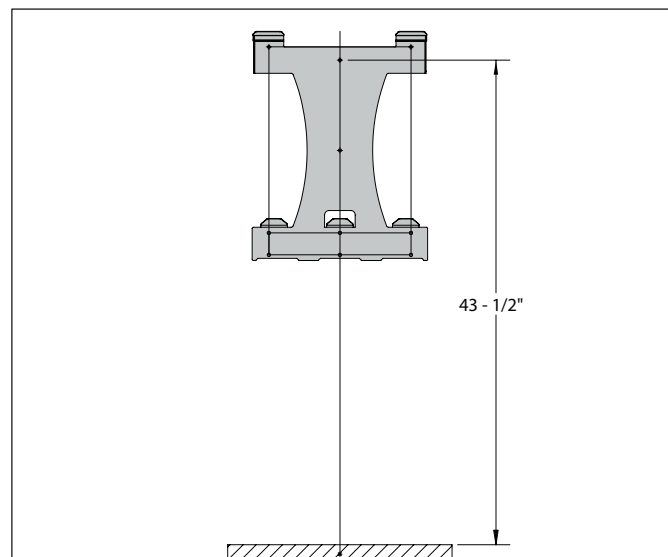
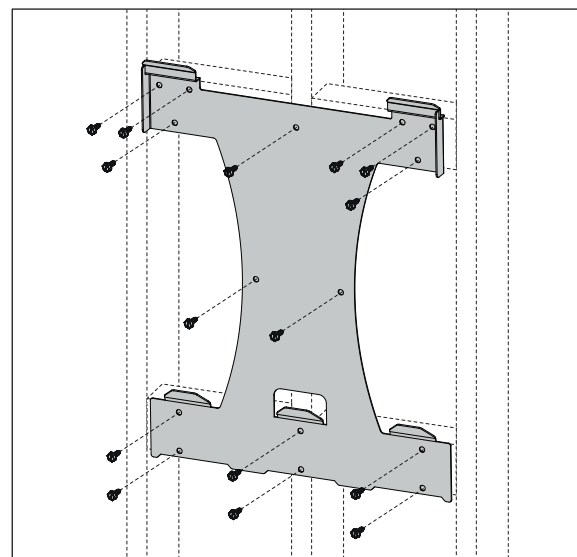

Fig 1B



# Installation Guide

## STEP 2

### Mounting the Unit

- 2.1 Hang the refrigerant side of the Bi-Level water cooler on the right side.
- 2.2 Hang the non-refrigerated unit on the left side.
- 2.3 If you haven't already, remove the front panels of both units by undoing the screws shown in Fig 2A.
- 2.4 Attach the units using the 7/16" wall anchor points indicated in Fig 2B. There will be two on each side.

Fig 2A

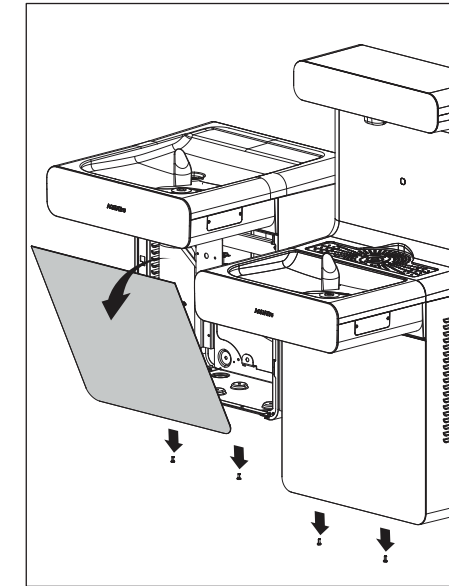
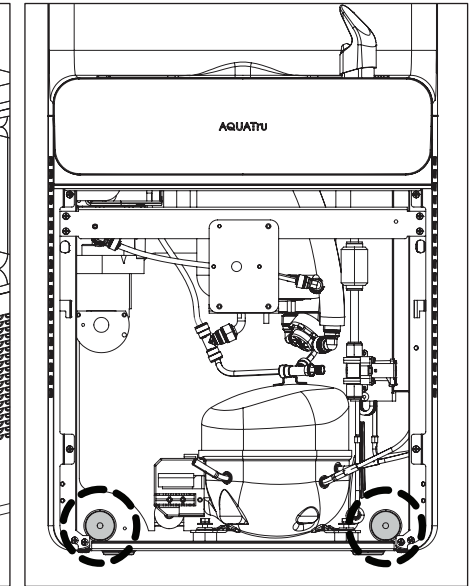

Fig 2B



## STEP 3

### Water Supply and Electrical

- 3.1 Connect the 3/8" water supply line to the inlet solenoid found in the main refrigerated unit and indicated in Fig 3A.
- 3.2 Now locate the two tubes connected to the **WHITE FILTER MANIFOLD** in the left side unit. This manifold will have a **YELLOW** sticker on it.
- 3.3 There are two different sizes of tubes routed to the Filter Manifold:
  - a. The 3/8" fitting needs to be connected to the Evaporator Tank. (Fig 3B - pg. 17)
  - b. The 1/4" tube needs to be connected to the Pressure Reducer. (Fig 3C - pg. 17)
- 3.4 Now connect all 3 of the water outlets to the T-Junctions located next to the compressor and tank. The exact connections will not matter, just make sure that 1 tube is routed to the Bottle Filler and 1 tube each for the two bubblers. (Fig 3D - pg. 18)
- 3.5 After connecting the water supply, connect the electrical connectors from the shell unit to the main unit and the bottle dispenser to the main control board. These connectors can be found in the circled areas of Fig 3E (pg. 18). The Large connector will connect the bottle filler to the control board and the small connector will connect the shell unit to the control board.

Fig 3A

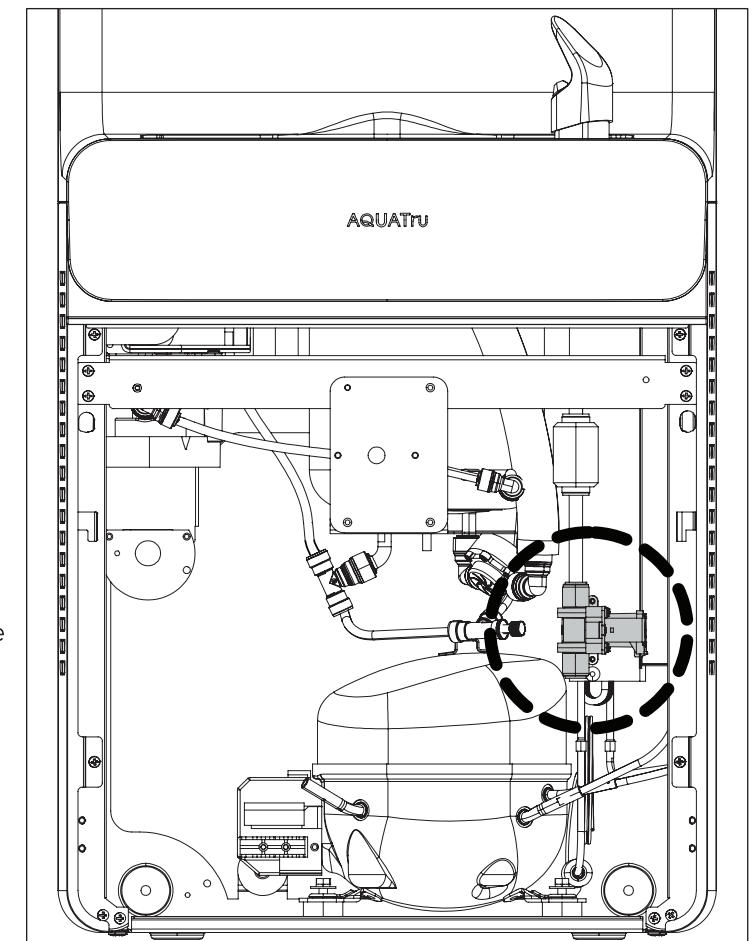



STEP  
**3**

## Water Supply and Electrical (Cont.)

Fig 3B

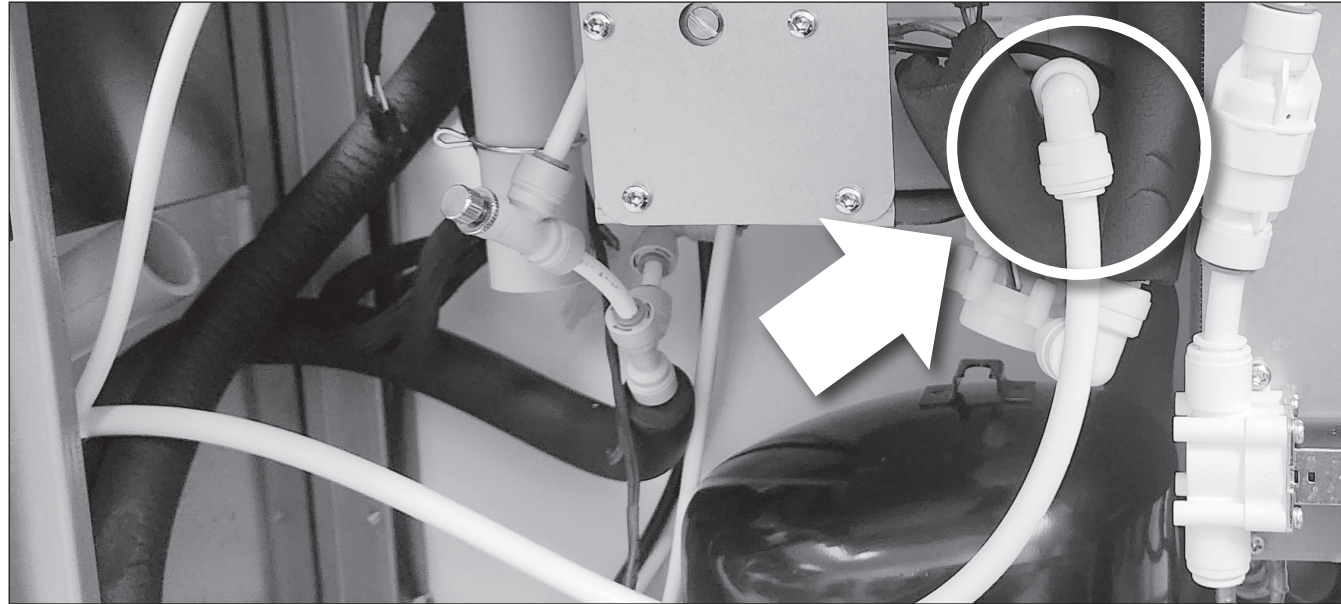

Fig 3C

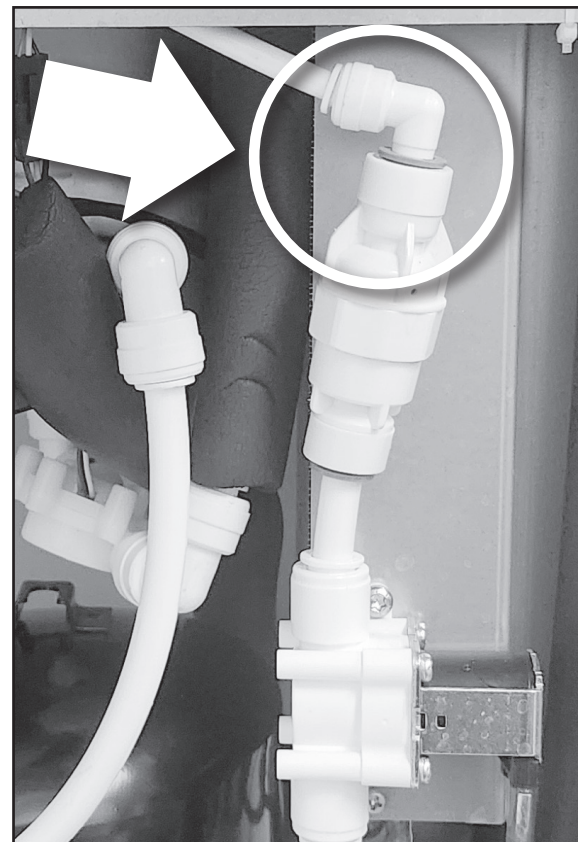

Fig 3D

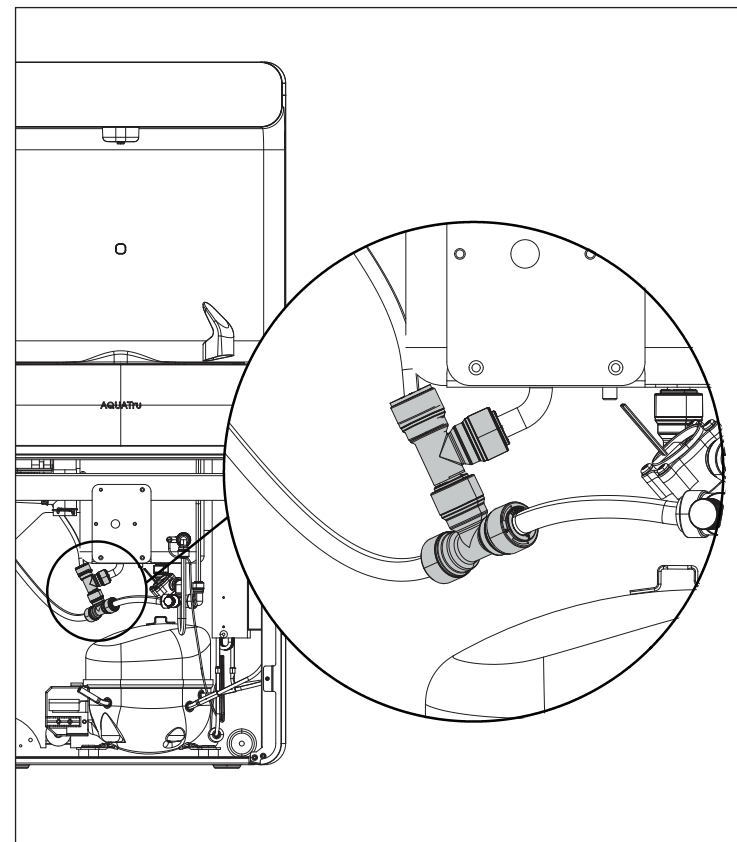
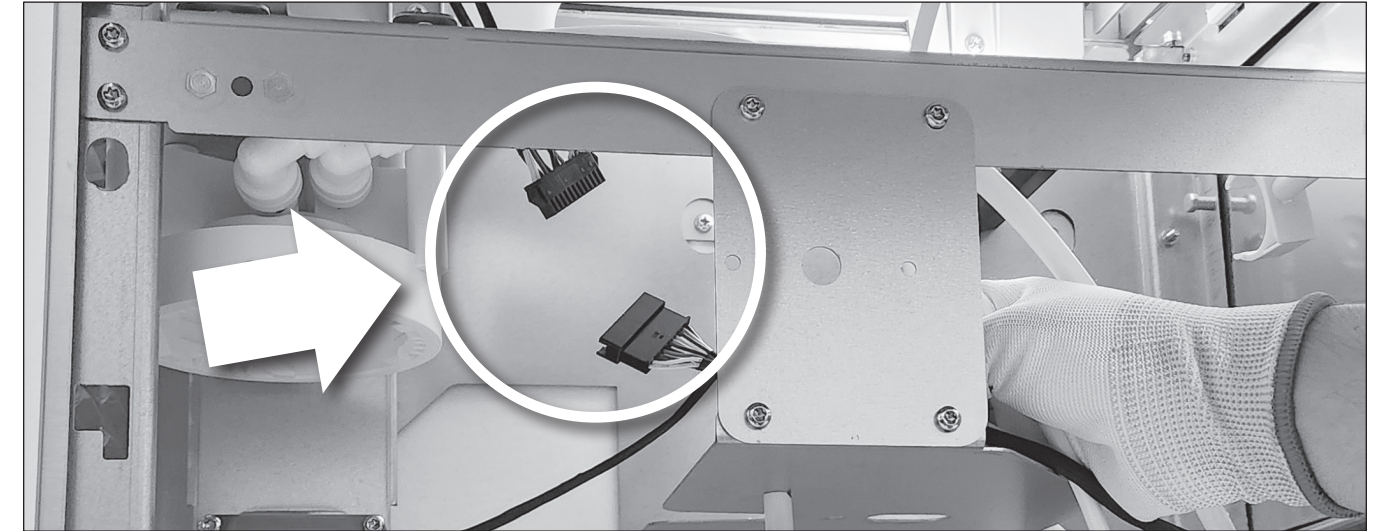

Fig 3E



STEP  
**4**

## Drain Connections

- 4.1 Locate the included Drain tubes and silicone connectors.
- 4.2 Install and assemble the drain tube components according to Fig. 4A.
- 4.3 It will be easiest to install the vertical tailpieces first and then connect the horizontal piece before attaching the assembly to the P-Trap (not included).
- 4.4 Now install the Pass through Cover by pinching together the top and bottom and sliding it into the gap. (Fig 4B)

Fig 4A

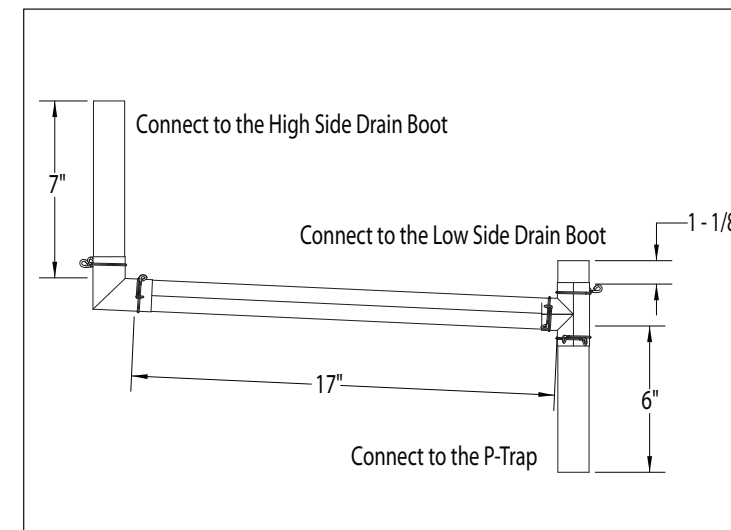

Fig 4B





## Installation Guide

STEP  
5

### Filter Install

- 5.1 Remove the included filter from its protective wrapping.
- 5.2 Remove the yellow protective sticker from the Filter Manifold.
- 5.3 Insert the filter into the Filter Manifold and quarter-turn it into place. The arrows on the filter and manifold should now align. (Fig. 5A)
- 5.4 Turn on the water supply and check for leaks.
- 5.5 Dispense water until the bottle counter reads 20. After you've done this, check again for leaks.

Fig 5A

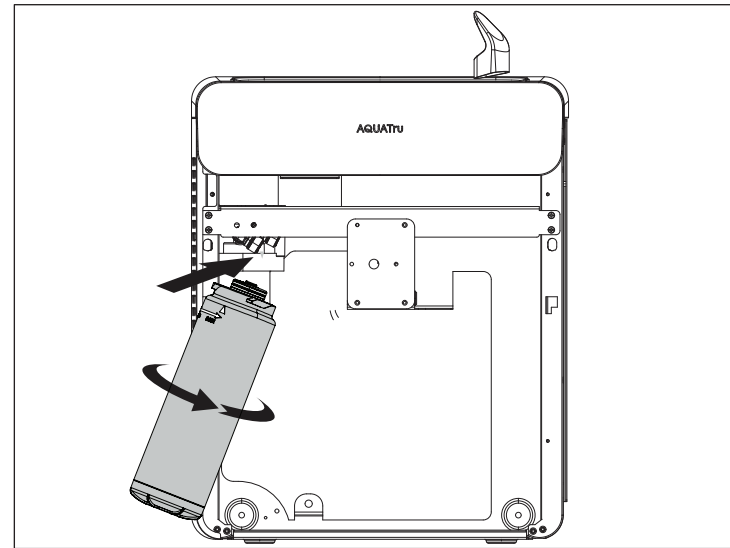

STEP  
6

### Adjust Bubbler Stream (You will need to follow similar steps on BOTH BUBBLERS.)

- 6.1 Locate the variable flow valve. There will be one behind the front panel found underneath **both bubblers**. (Fig 6A)
- 6.2 Turning Left increases the flow while turning right reduces the flow. (Fig 6B)
- 6.3 Adjust the flow until the water stream reaches a height of approximately 4 inches above the sink basin (Fig 6C)
- 6.4 Reinstall the front covers and replace the 4 front screws (Fig 6D)

Fig 6A

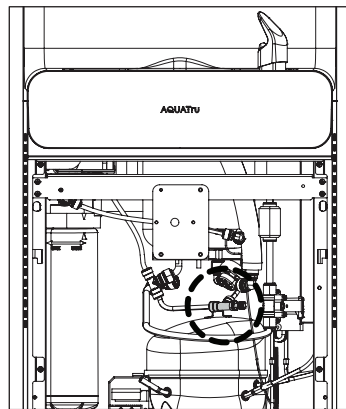

Fig 6B

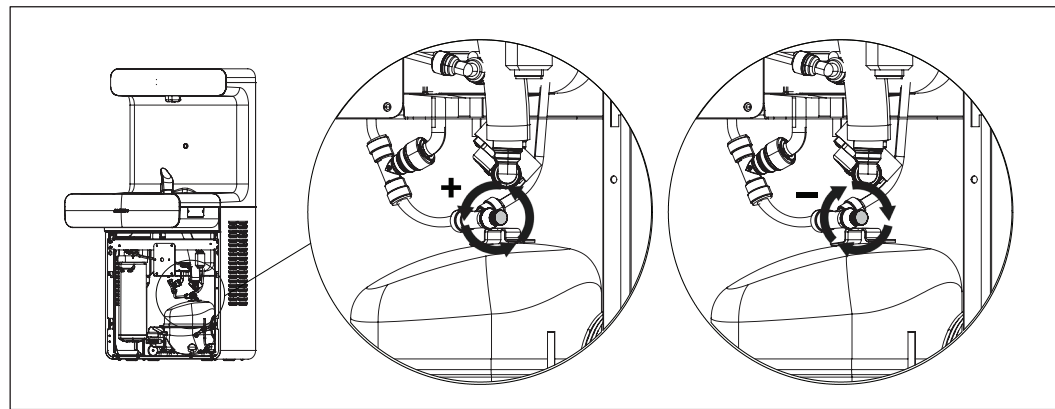

Fig 6C

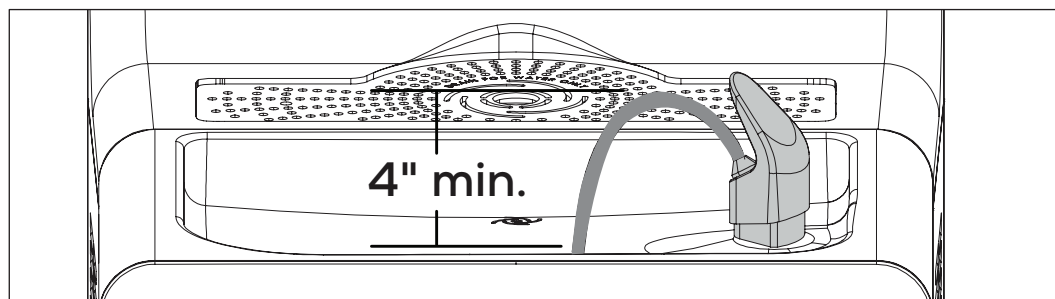
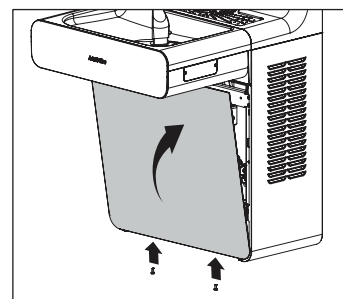

Fig 6D



## Filter Replacement Instructions

### Filter Replacement

1. First, remove the two screws under the front of the unit shown in Fig 1.
2. Then remove the front cover by pushing up on the bottom of the panel and gently pulling one of the corners toward you. (Fig 2)
3. Remove the filter currently installed in the unit by twisting it counterclockwise. (Fig 3)
4. Install the new filter by twisting it clockwise into the Filter Manifold. (Fig 4)
5. Replace the front cover and reinstall the screws on the bottom cover. (Fig 5)

REPLACEMENT FILTER PART NUMBER: ATW1-F1

Fig 1

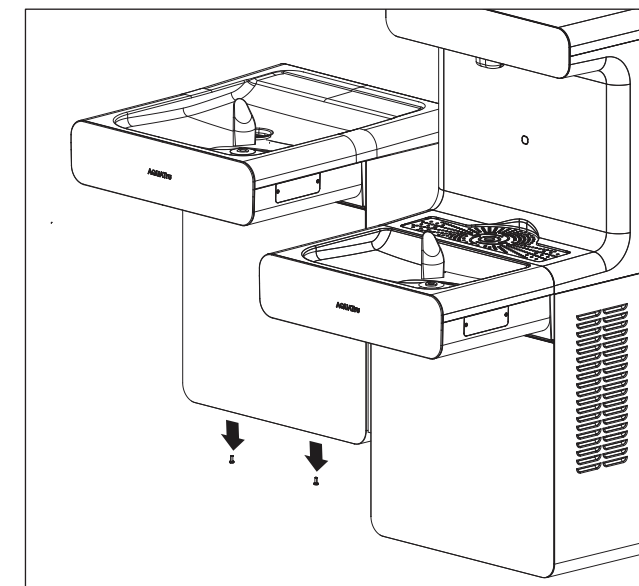

Fig 3

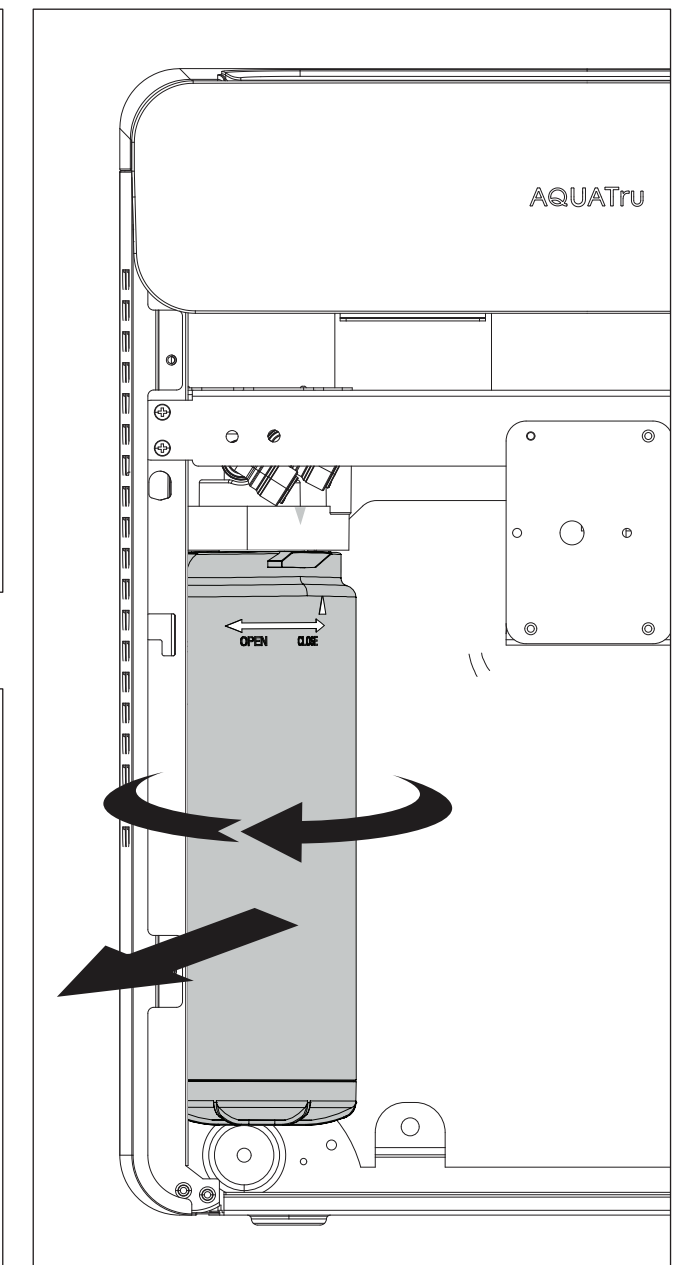
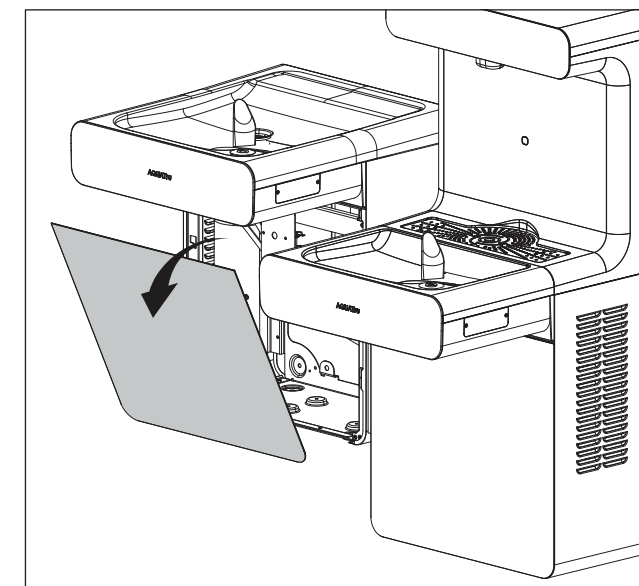

Fig 2



## Filter Replacement Instructions

Fig 4

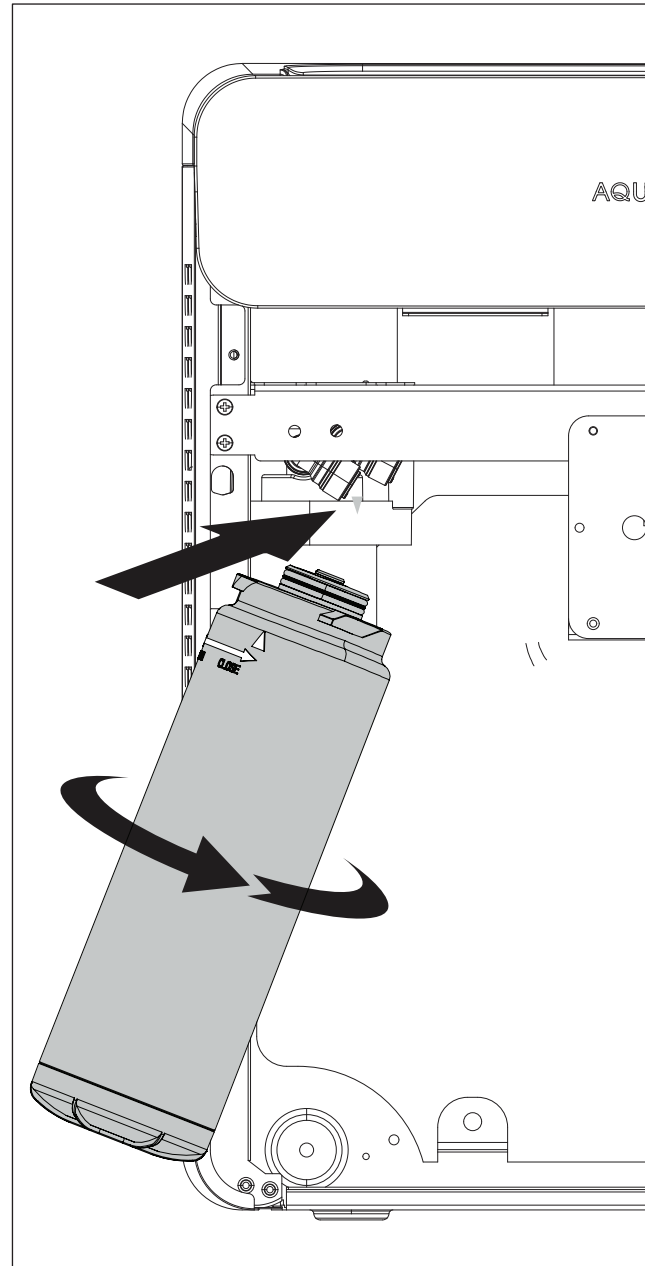
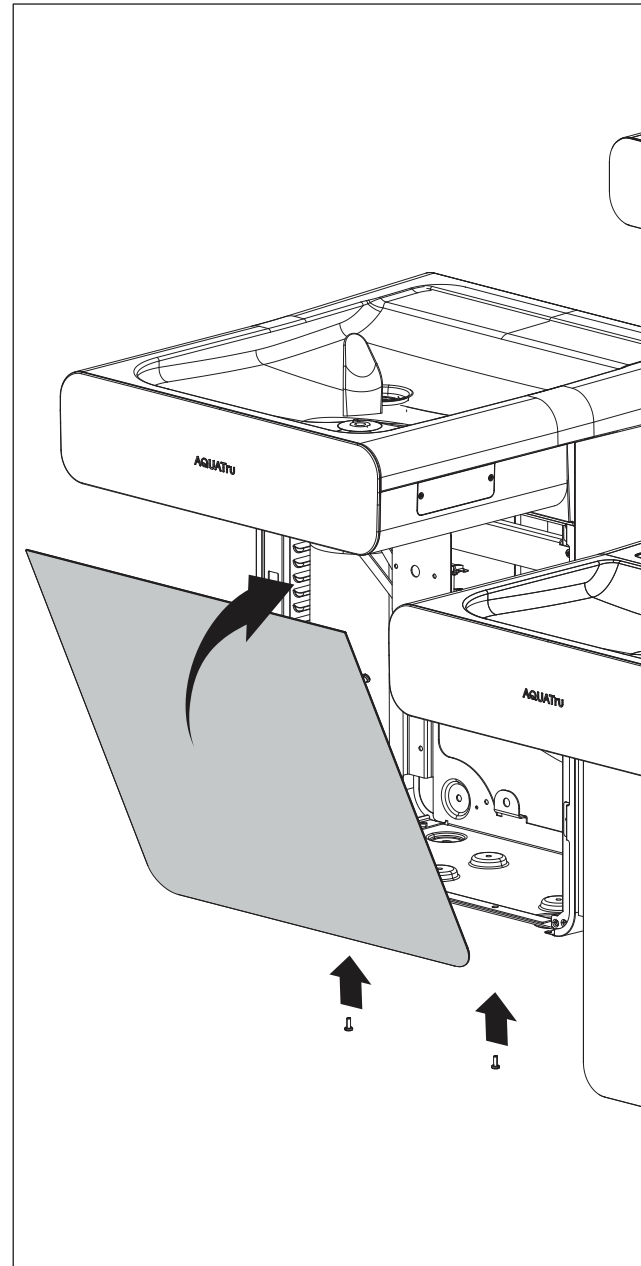

Fig 5



## Control Panel

### Display

- 1. Bottles Saved Counter:**  
Counts the number of 16oz Bottles that this device has prevented from entering a land fill.
- 2. Filter Life Indicator:**  
These six LEDs show the remaining capacity of the filter. The more lights that are illuminated, the more time and volume you have remaining in your filter. When the filter life nears capacity the lights will turn orange. At this time, we recommend reordering filters if you do not have replacements.
- 3. Change Filter Indicator:**  
Once the filter capacity is completely used up, the words "CHANGE FILTER" will illuminate in red.

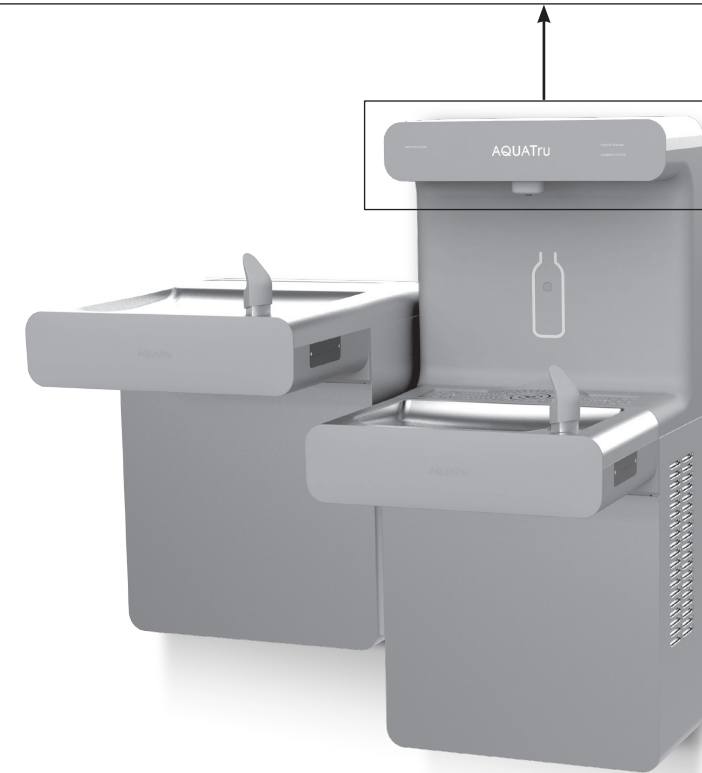

## Service

### Cleaning

#### 1. Stainless Steel

**General Cleaning:** Use an ordinary mild detergent and a soft cloth. Rinse and towel dry when finished.  
**DO NOT USE BLEACH OR PRODUCTS THAT CONTAIN BLEACH ON STAINLESS STEEL, IT CAN AFFECT THE CORROSION RESISTANCE.**

Light scratches are normal.

#### 2. Plastic

**General Cleaning:** Use an ordinary mild detergent and a soft cloth. Rinse and towel dry when finished.  
Wiping the surfaces will not hurt anti-microbial properties.

### Temperature Control

The factory sets the thermostat to 50 +/- 5 °F under normal conditions. To adjust the temperature, refer to the sticker on the Temperature Control Valve located near the Compressor and Cold Tank.

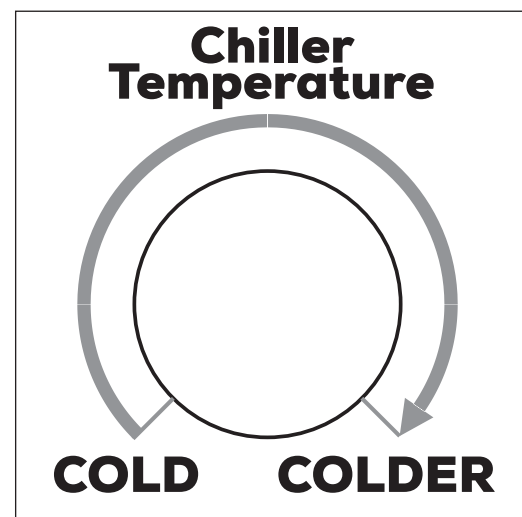

## Service: Wiring Diagram

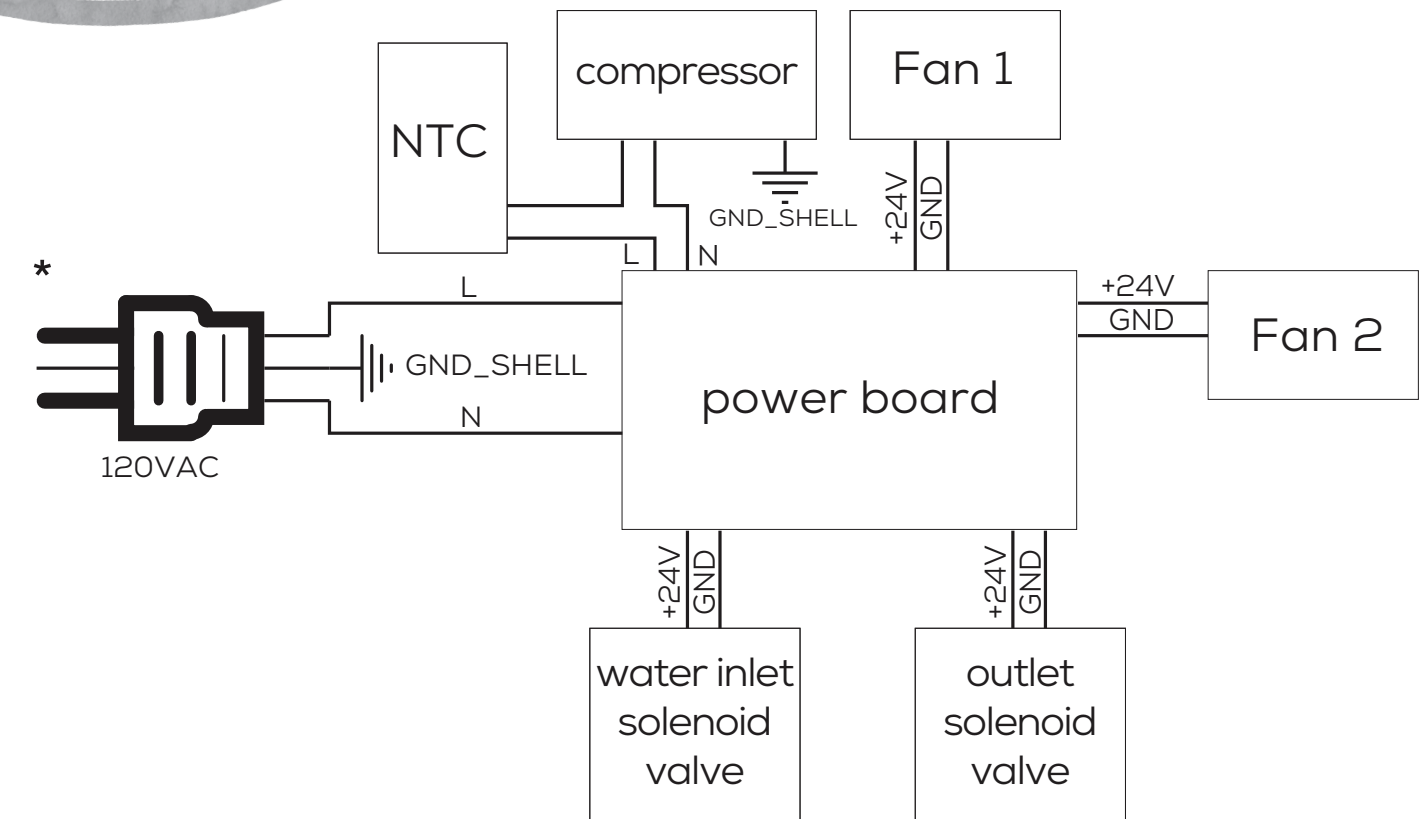

### Error Codes

ERROR CODE	ERROR	CAUSE	SOLUTION
A00	The Water Cooler does not detect a genuine AquaTru Filter.	The system does not detect a genuine AquaTru Filter.	<ol style="list-style-type: none"> <li>1. Make sure that a genuine AquaTru Filter is installed.</li> <li>2. Make sure that the filter is fully inserted into the filter manifold.</li> <li>3. Make sure that the filter is installed in the correct orientation.</li> <li>4. The Filter Scanner may have shifted during transportation. Gently pull on it (located behind the filter) to move it closer to the filter.</li> </ol>
A02	Refrigeration failure.	Compressor has not activated more than 3 times in a 3 hour span or there is no signal from the cooling system.	<ol style="list-style-type: none"> <li>1. Check that the filter is installed correctly.</li> <li>2. Unplug the system.</li> <li>3. Check to make sure there is a voltage from the temperature sensor.</li> <li>4. Plug the system back in.</li> <li>5. Wait 5 minutes to make sure the fan is turning on.</li> </ol> <p>If the fan turns on the system is good to go. If the fan does not turn on or you experience this issue repeatedly reach out to customer support.</p>



## Warranty Information

### Limited Warranty for AquaTru On-Wall Bi-Level Bubbler With Bottle Filler

Your AquaTru On-Wall Filling Station is warranted to be free from defects in materials and workmanship for one year from the original purchase date or eighteen (18) months from the date of shipment from the factory, whichever occurs first. Should the product have a defect in materials or workmanship, we will repair or replace parts without charge to you (a shipping and processing fee will apply). The warranty **does not include filters**. For the Warranty to apply the unit must be installed by a certified plumber and operated in accordance with the Manufacturer's written instructions included with each unit. To obtain service under warranty, simply call our customer service center toll-free at **800-919-7966** or **email at aqtservice@idealliving.com**.

This warranty does not cover damage caused by accident, misuse, or any use other than as intended and described in this product manual, or damage resulting from failure to maintain and clean this product as specified in this product manual. This warranty applies only to the original purchaser of the AquaTru On-Wall Filling Station.

**ALL EXPRESS AND IMPLIED WARRANTIES FOR THIS PRODUCT, INCLUDING IMPLIED WARRANTIES OF MERCHANTABILITY AND FITNESS FOR A PARTICULAR PURPOSE, ARE LIMITED IN DURATION TO THE WARRANTY PERIOD, AND NO WARRANTIES, WHETHER EXPRESS OR IMPLIED, WILL APPLY AFTER THIS PERIOD.**

**SECOND THROUGH FIFTH YEARS WARRANTY FOR AQUATRU ON-WALL FILLING STATION** - Manufacturer warrants the compressor and related cooling or heating parts including cooling coils or tank assembly when part of the refrigeration system, to be free from defects in material and workmanship under normal use for an additional four (4) years from the end of the one (1) year period described above.

Some states do not allow limitations on the duration of implied warranties, so the above limitation may not apply to you. While this warranty gives you specific legal rights, you may also have other rights, which may vary from state to state.

#### Contact Info for Warranty Service:

Ideal Living  
P.O. Box 9169 | Van Nuys, CA | 91409-9169  
855-246-9202 | [enterprise.idealliving.com](http://enterprise.idealliving.com)



## Arbitration Agreement

**PLEASE READ THIS AGREEMENT CAREFULLY. YOU ACCEPT THE TERMS OF THIS AGREEMENT BY RETAINING THE PRODUCT(S) SHIPPED IN CONNECTION WITH THIS AGREEMENT (THE "PRODUCTS") FOR MORE THAN THIRTY (30) DAYS AFTER RECEIPT. IF YOU DO NOT AGREE TO THE TERMS OF THIS AGREEMENT, YOU MAY RETURN THE PRODUCT TO THE COMPANY WITHIN THIRTY (30) DAYS OF RECEIPT FOR A FULL REFUND.**

**THIS ARBITRATION AGREEMENT ("AGREEMENT") AFFECTS YOUR LEGAL RIGHTS AND REMEDIES BY PROVIDING THE DISPUTES BETWEEN YOU AND THE MANUFACTURER, DISTRIBUTOR AND/OR SELLER OF THIS PRODUCT (COLLECTIVELY, "COMPANY"), MUST BE RESOLVED THROUGH BINDING ARBITRATION AND NOT IN COURT. IT ALSO PROVIDES THAT ANY DISPUTE CANNOT BE RESOLVED IN A CLASS ACTION OR OTHER PROCEEDING WHERE YOU REPRESENT OTHER PERSONS OR OTHER PERSONS REPRESENT YOU, AND THAT NO CLASS OR REPRESENTATIVE ARBITRATIONS ARE PERMITTED. PLEASE CAREFULLY READ ALL TERMS IN THIS AGREEMENT.**

### 1. RESOLUTION OF CLAIMS OR DISPUTES.

Any claim or dispute between you and Company (or any of Company's subsidiaries or affiliates) arising out of or relating in any way to the Product or this Agreement shall be resolved through final, binding arbitration. This arbitration obligation is reciprocally binding on both you and the Company and applies regardless of whether the claim or dispute involves a tort, fraud, misrepresentation, product liability, negligence, violation of a statute, or any other legal theory. Both you and Company specifically acknowledge and agree that you waive your right to bring a lawsuit based on such claims or disputes and to have such lawsuit resolved by a judge or jury.

### 2. LIMITATION OF LEGAL REMEDIES.

All arbitrations under this Agreement shall be conducted on an individual (and not a class wide) basis, and an arbitrator shall have no authority to award class wide relief. You acknowledge and agree that this Agreement specifically prohibits you and the Company from commencing arbitration proceedings as a representative of others or joining in any arbitration proceedings brought by any other person. The parties agree that no class or representative actions of any type are permitted.

### 3. ARBITRATION PROCEDURES.

- a. Before instituting an arbitration, if you have any dispute, we strongly encourage you to contact the Company to try to resolve the matter by calling 800-919-7966, although you are not required to do so.
- b. The arbitration of any claim or dispute under this Agreement shall be conducted in accordance with the expedited procedures set forth in the JAMS Comprehensive Arbitration Rules and Procedures as those Rules exist on the date you receive the Product, including Rules 16.1 and 16.2 of those Rules. These rules and procedures are available by calling JAMS or by visiting its website at jamsadr.com. The arbitration of any claim or dispute under this Agreement shall be conducted by an arbitrator who has at least five years of experience conducting arbitrations.
- c. The arbitration of any claim or dispute under this Agreement shall be conducted in the State of California or the location in which you received this Agreement. For claims of \$10,000 or less, you may choose whether the arbitration proceeds in person, by telephone, or based only on submissions.
- d. The Company shall pay costs for the arbitration of claims, including any JAMS Case Management Fee and all professional fees for the arbitrator's services. The Company shall pay the fees and costs of its own counsel, experts and witnesses and shall not be able to recoup them from you even if you do not prevail in the arbitration. Unless otherwise provided by law, you acknowledge and agree that you shall pay the fees and costs of your own counsel, experts and witnesses.

### 4. CHOICE OF LAW.

The arbitration provisions of this Agreement and any arbitration conducted pursuant to the terms of this Agreement shall be governed by the Federal Arbitration Act (9 U.S.C. Secs. 1-16). In this respect, the parties acknowledge that this Agreement involves a transaction conducted in interstate commerce. Otherwise, this Agreement and the rights of the parties hereunder shall be governed by and construed in accordance with the laws of the State of California, exclusive of conflict or choice of law rules.

### 5. SEVERABILITY.

If any provision of this Agreement is declared or found to be unlawful, unenforceable or void, such provision will be ineffective only to the extent that it is found unlawful, unenforceable or void, and the remainder of the provision and all other provisions shall remain fully enforceable.

## Acuerdo de Arbitraje

**LEA ATENTAMENTE ESTE ACUERDO. USTED ACEPTA LOS TÉRMINOS DE ESTE ACUERDO AL CONSERVAR EL PRODUCTO (LOS PRODUCTOS) ENVIADOS BAJO A ESTE ACUERDO (LOS "PRODUCTOS") POR MÁS DE TREINTA (30) DÍAS DESPUÉS DE SU RECEPCIÓN. SI NO ESTÁ DE ACUERDO CON LOS TÉRMINOS DE ESTE ACUERDO, PUEDE DEVOLVER EL PRODUCTO A LA EMPRESA EN UN PLAZO DE TREINTA (30) DÍAS A PARTIR DE HABERLO RECIBIDO PARA OBTENER UN REEMBOLSO COMPLETO.**

**TESTE ACUERDO DE ARBITRAJE ("ACUERDO") AFECTA A SUS DERECHOS Y RECURSOS LEGALES AL ESTABLECER QUE LAS DISPUTAS ENTRE USTED Y EL FABRICANTE, DISTRIBUIDOR Y/O VENDEDOR DE ESTE PRODUCTO (COLECTIVAMENTE, "COMPAÑÍA"), DEBEN RESOLVERSE MEDIANTE ARBITRAJE VINCULANTE Y NO EN LOS TRIBUNALES. TAMBIÉN ESTABLECE QUE CUALQUIER DISPUTA NO PUEDE SER RESUELTA EN UNA ACCIÓN COLECTIVA U OTRO PROCEDIMIENTO EN EL QUE USTED REPRESENTE A OTRAS PERSONAS O QUE OTRAS PERSONAS LE REPRESENTEN A USTED, Y QUE NO SE PERMITEN ARBITRAJES COLECTIVOS O REPRESENTATIVOS. POR FAVOR LEA DETENIDAMENTE TODOS LOS TÉRMINOS DE ESTE ACUERDO.**

### 1. RESOLUCIÓN DE RECLAMACIONES O DISPUTAS.

Cualquier reclamación o disputa entre usted y la Compañía (o cualquiera de las subsidiarias o filiales de la Compañía) que surja o esté relacionada de alguna manera con el Producto o este Acuerdo se resolverá mediante un arbitraje final y vinculante. Esta obligación de arbitraje es recíprocamente vinculante tanto para usted como para la Compañía y se aplica independientemente de si la reclamación o disputa implica un agravio, fraude, tergiversación, responsabilidad por el producto, negligencia, violación de una ley o cualquier otra teoría legal. Tanto usted como la Compañía reconocen y aceptan específicamente que renuncian a su derecho a presentar una demanda judicial basada en dichas reclamaciones o disputas y a que dicha demanda sea resuelta por un juez o un jurado.

### 2. LIMITACIÓN DE LOS RECURSOS LEGALES.

Todos los arbitrajes en virtud del presente Acuerdo se llevarán a cabo de forma individual (y no colectiva), y un árbitro no tendrá autoridad para conceder una reparación colectiva. Usted reconoce y acepta que este Acuerdo le prohíbe específicamente a usted y a la Compañía iniciar procedimientos de arbitraje como representante de otros o unirse a cualquier procedimiento de arbitraje presentado por cualquier otra persona. Las partes acuerdan que no se permiten acciones colectivas o representativas de ningún tipo.

### 3. PROCEDIMIENTOS DE ARBITRAJE.

- a. Antes de iniciar un arbitraje, si tiene alguna disputa le recomendamos encarecidamente que se ponga en contacto con la Compañía para intentar resolver el asunto llamando al 800-919-7966, aunque no está obligado a hacerlo.
- b. El arbitraje de cualquier reclamación o disputa en virtud de este Acuerdo se llevará a cabo de acuerdo con los procedimientos acelerados establecidos en las Normas y Procedimientos de Arbitraje Integrales de JAMS, tal y como existían en la fecha en que usted recibió el Producto, incluidas las Normas 16.1 y 16.2 de dichas Normas. Estas normas y procedimientos están disponibles llamando a JAMS o visitando su sitio web en [www.jamsadr.com](http://www.jamsadr.com). El arbitraje de cualquier reclamación o disputa en virtud de este Acuerdo será llevado a cabo por un árbitro que tenga al menos cinco años de experiencia en la realización de arbitrajes.
- c. El arbitraje de cualquier reclamación o disputa en virtud de este Acuerdo se llevará a cabo en el Estado de California o en el lugar en el que usted recibió este Acuerdo. En el caso de reclamaciones de \$10,000 o menos, usted podrá elegir si el arbitraje se lleva a cabo en persona, por teléfono o únicamente basado en la presentación de documentación.
- d. La Compañía pagará los costes del arbitraje de las reclamaciones, incluyendo cualquier tasa de gestión de casos de JAMS y todos los honorarios profesionales por los servicios del árbitro. La Compañía pagará los honorarios y costes de sus propios abogados, peritos y testigos y no podrá recuperarlos de usted aunque no prevalezca en el arbitraje. A menos que la ley disponga lo contrario, usted reconoce y acepta que pagará los honorarios y costes de su propio abogado, peritos y testigos.

### 4. ELECCIÓN DE LA LEY.

Las disposiciones de arbitraje de este Acuerdo y cualquier arbitraje llevado a cabo de conformidad con los términos de este Acuerdo se regirán por la Ley Federal de Arbitraje (9 U.S.C. Artículos 1-16). A este respecto, las partes reconocen que este Acuerdo implica una transacción realizada en el comercio interestatal. Por lo demás, el presente Acuerdo y los derechos de las partes en virtud del mismo se regirán e interpretarán de acuerdo con las leyes del Estado de California, excluyendo las normas de conflicto o elección de la ley.

### 5. DISPOSICIONES INDEPENDIENTES.

Si alguna de las disposiciones del presente Acuerdo se declara o se considera ilegal, inaplicable o nula, dicha disposición será ineficaz sólo en la medida en que se considere ilegal, inaplicable o nula, y el resto de las disposiciones y todas las demás cláusulas seguirán siendo aplicables plenamente.



## Main Parts - SKU Listing

DIAGRAM #	PART DESCRIPTION	SKU
1	Control Panel	10AT01WFP01
2	Display Guide	10AT01WFP02
3	Light Cover	10AT01WFP03
4	Screen PCB	10AT01WFP04
5	Elbow Connector 1/4" to 3/8"	10AT01WFP05
6	3/8" Solenoid Valve	10AT01WFP06
7	Laminar Flow Fitting	10AT01WFP07
8	Dispensing Tube	10AT01WFP08
9	Dispensing Tube Cover	10AT01WFP09
10	Bottle Sensor Lens	10AT01WFP10
11	Bottle Sensor	10AT01WFP11
12	Dispenser Top	10AT01WFP12
13	Top Cover Support	10AT01WFP13
14	Bottle Dispenser	10AT01WFP14
15	Drip Tray Gasket	10AT01WFP15
16	Drip Tray	10AT01WFP16
17	Drain Basin	10AT01WFP17
18	Drain Tube Boot	10AT01WBP18
19	Drain Tube Lock Collar	10AT01WBP19
20	Short Drain Tube	10AT01WBP20
21	Left Frame	10AT01WFP21
22	Side Panel	10AT01WBP22
23	1/4" PE Tube	10AT01WFP23
24	Front Panel	10AT01WBP24
25	Bottle Counter Reset Switch	10AT01WFP25
26	Front Brace	10AT01WFP26
27	Evaporator (Tank)	10AT01WFP27
28	Flow Meter	10AT01WFP28
29	Thermostat	10AT01WFP29
30	Thermostat Mount	10AT01WFP30
31	Wall Mounting Bracket	10AT01WFP31
32	Back Panel	10AT01WFP32
33	Condenser	10AT01WFP33
34	Fan	10AT01WFP34
35	Fan Cowling	10AT01WFP35
36	Right Side Frame	10AT01WFP36
37	Side Panel	10AT01WFP37
38	Big O-ring	10AT01WFP38
39	Filter Base	10AT01WFP39
40	Small Oring	10AT01WFP40
41	Carbon Top Cap	10AT01WFP41
42	Carbon Block	10AT01WFP42
43	Carbon Bottom Cap	10AT01WFP43
44	Filter End Cap	10AT01WFP44
45	Filter Manifold	10AT01WFP45
46	Valve Stem	10AT01WFP46
47	Spring	10AT01WFP47
48	Flow Wiper	10AT01WFP48
49	Flow Wiper Cover	10AT01WFP49
50	NFC Reader	10AT01WFP50

DIAGRAM #	PART DESCRIPTION	SKU
51	NFC Mounting Bracket	10AT01WFP51
52	Filter Manifold Bracket	10AT01WFP52
53	Control Board Mounting Bracket	10AT01WFP53
54	Bubbler Control Board	10AT01WFP54BL
55	Control Board Cover	10AT01WFP55
56	Compressor	10AT01WFP56
57	3/8" PE Tube	10AT01WFP57
58	Pressure Regulator	10AT01WFP58
59	Copper Pipe	10AT01WFP59
60	Refrigerant Filter	10AT01WFP60
61	Elbow Connector 3/8" to 3/8"	10AT01WFP61
62	Connector 1/4 to 3/8 (Female to Male)	10AT01WFP62
63	Elbow 5/16 to 3/8	10AT01WFP63
64	Elbow Connector 1/4 X 3/8 ( Female to Female)	10AT01WFP64
65	Bubbler	10AT01WBP65
66	Basin	10AT01WBP66
67	Silicone Bumper	10AT01WBP67
68	Silicone Bumper Gasket	10AT01WBP68
69	Hand Sensor Cover	10AT01WBP69
70	Basin Support	10AT01WBP70
71	Basin Left Cantilever Support	10AT01WBP71
72	Basin Left Triangulated Support	10AT01WBP72
73	Right Side IR Sensor Cover	10AT01WBP73
74	1/4" Solenoid Valve	10AT01WBP74
75	Connector 1/4 X 1/4 (Male to Female)	10AT01WBP75
76	Bubbler Right Cantilever Support	10AT01WBP76
77	Basin Right Triangulated Support	10AT01WBP77
78	Small Basin Drain Lock	10AT01WBP78
79	Spring Fastener	10AT01WBP79
80	T-Joint 1/4 X 3/8 X 1/4	10AT01WBP80
81	Throttle Valve	10AT01WBP81
82	Basin Front Cover	10AT01WBP82
83	Basin Bottom Cover	10AT01WBP83
86	T Joint 1/4" to 1/4" to 1/4"	10AT01WBP86
87	Large Basin	10AT01WBP87
88	Large Basin Support	10AT01WBP88
89	Drain Hose Assembly	10AT01WBP89
90	Large Basin Drain Lock	10AT01WBP90
91	Small Wall Bracket	10AT01WBP91
92	High Side Panel	10AT01WBP92
93	Pass-Through Cover	10AT01WBP93
94	Strengthening Plate	10AT01WBP94
95	Right Stiffener Plate	10AT01WBP95
96	Left Stiffener Plate	10AT01WBP96
97	Tube Support	10AT01WBP97
98	Elbow Drain Boot	10AT01WBP98
99	T - Drain Boot	10AT01WBP99